

DIGITAL CLINICAL THERMOMETER

MODEL ACT3230ExA-XX

This thermometer is conformed to all requirements of European Norm ISO 80601-2-56 and ASTM E 1112.

1. Intended use

The product is used to measure people's human body temperature at hospital and home. It is used for the temperature measurement of oral, armpit and anus.

2. Schema of Thermometer

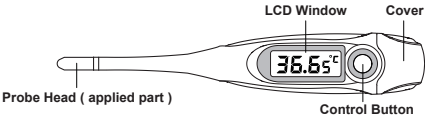

3. Specifications

- 3.1 Operating principle: Thermometer is designed on sensor's reaction to temperature
- 3.2 Measuring range: 32 °C ~ 42.9 °C or 90.0 °F ~ 109.9 °F
- 3.3 Accuracy: ± 0.1 °C or ± 0.2 °F
- 3.4 Display resolution: 0.1 °C or 0.1 °F
- 3.5 Power supply: 1 Button Battery 1.5V LR41 or similar (1000 measurements)
- 3.6 Weight / Dimensions
- 3.7 Ambient operating temperature: 5 °C ~ 40 °C or 41 °F ~ 104 °F at 15% ~ 90% RH
- 3.8 Storage / transportation temperature: -25 °C ~ +70 °C / -13 °F ~ +158 °F at 15% ~ 90% RH
- 3.9 Atmospheric pressure: 700 hPa -1060 hPa
- 3.10 Life time: 5 years
- 3.11 Shelf life of battery: 1 year (non-use, at storage temperature of 20 ± 3 °C)
- 3.12 Direct mode; time response 60sec; intermittent measurement; continuous operation
- 3.13 Safe-Test Alarm/ Memory/ Beeper/ IP22

4. How to switch between °C and °F (This function is only applicable in dual scale model)

- 4.1 Turn off the thermometer first, Press the ON/OFF button 2 times (one right after another) to start the thermometer, and keep it pressed until full display finishes. The unit will change after full display.
- 4.2 Symbol () or () appears after unit successfully changes, then release the ON/OFF button. Now, the thermometer is ready for temperature taking.

5. How to operate

- 5.1 Press down ON/OFF button to start the thermometer. A full display () or () ensures that LCD window is in good function.
- 5.2 Hold on a second for internal safe testing. If () alerts its malfunction, stop operate the thermometer.
- 5.3 LCD window appears last measurement result for 2 second and displays () (). Then the ambient temperature or () () displays on window with °C/ °F blinking. The thermometer now is ready for a temperature taking.
- 5.4 Clean or disinfect the probe before every measurement. Put the probe head (applied part) under tongue, arms, or in rectum, according to the methods provided. (see6. Methods of Use)
- 5.5 As soon as the thermometer does not register any further relevant increase in temperature, "°C/ °F" stops flashing and the maximum value measured up to that time is shown with 10 second beep.
- 5.6 After the beep sounds, the thermometer continues measuring the temperature until it automatically turns off (9 minutes). Meanwhile, measured temperature keeps being displayed on LCD window. And in this time there may possibly be a further slight increase in the temperature shown on LCD widow. After that, the maximum temperature measured will be recorded and stored.
- 5.7 When the measured temperature is above or below Measuring range, the LCD window displays () () or () (). Please follow the instruction booklet to re-operate the thermometer under the ambient temperature. Please consult a physician or other medical professionals for further advice of measurement result.
- 5.8 The thermometer has auto shut-off function. The thermometer will automatically turn off in case of not using it in 9 minutes. To extend its battery life, please turn off the thermometer after using it.
- 5.9 To recall the last temperature. Please turn on the thermometer, and the last temperature will be recalled on LCD window with "M" flag appeared at right-bottom corner after a full display.
e.g., () or () () or ()

6. Methods of Use

- 6.1 Axillary Measurement (approximately 15 - 25 seconds)
Dry the armpit with a towel. Place the probe head under the armpit. Close the arm firmly.
- 6.2 Oral Measurement (approximately 10 - 20 seconds)
Place the probe head under the tongue. Assure a fixed and good contact. Close the mouth and breathe normally.
- 6.3 Rectal Measurement (approximately 10 - 15 seconds)
Lubricate the probe head with Vaseline for an easier insertion. Then, softly enforce the probe head into the rectum approximately 2 to 3 cm in depth.

7. How to Replace the Battery

- When the battery flag () appears and blinks, it means the battery should be replaced.
- 7.1 Turn off the thermometer and pull out the battery cover by gently pressing on the catch.
- 7.2 Remove the used battery by any pointed object but not sharp metal.
- 7.3 Disposed of used battery properly.
- 7.4 Replace with a new button battery 1.5V, with the Anode side (+) upward as the following illustration.
- 7.5 Close the cover securely.

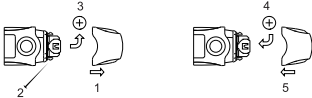

Note: it is important to turn the instrument off before replacing the battery otherwise the thermometer may malfunction.

8. How to Clean and How to Disinfect

- 8.1 Please always clean and disinfect the probe head before and after each use with mild soapy water, clean cloth or 70% isopropyl alcohol.
- 8.2 Do not boil or clean and disinfect in washing machine.

9. Caution

- 9.1 Do not boil, bite, bend, drop or disassemble this thermometer.
- 9.2 If used this thermometer is not according to the use instructions, the manufacturer cannot be held liable for damage caused by incorrect application.
- 9.3 Do not dispose this thermometer and its battery into fire. Battery must be recycled or disposed of in properly.
- 9.4 Always keep this thermometer away from direct sunlight, moisture, extreme temperature and dirt while use, store or transport.
- 9.5 If the thermometer was stored in an extreme condition (-25 °C or 70 °C) or operating ambient temperature is higher than normal temperature, please immerse the probe head into cold water for 5-10 seconds before temperature taking.
- 9.6 For long durations of non-operation, please remove all batteries from the device. (If it is not used for 1 month, it is recommended to remove the battery).
- 9.7 Although the patient is an intended operator, this product is not intended to diagnose or treat any health problem or disease and should not be used as a substitute for the consultation and advice of a physician or other medical professionals.
- 9.8 This thermometer contains small parts that can be swallowed or produce a choking hazard to children, and keep the thermometer out of children's reach.
- 9.9 It is recommended to have the device inspected every two years to ensure correct function and accuracy with application laboratory and authorized service center.
- 9.10 Do not modify and maintenance this equipment without authorization.
- 9.11 Avoid taking temperature in 30 minutes after physical exercised, bathing or dining.
- 9.12 Use of this equipment adjacent to or stacked with other equipment should be avoided because it could result in improper operation. If such use is necessary, this equipment and the other equipment should be observed to verifythat they are operating normally.
- 9.13 Please follow your government's environment policy to recycle the thermometer, accessories and batteries.

10. Warranty

- 10.1 This thermometer has an one year warranty from the date of purchase and this warranty is effective only by presenting the **RECEIPT OF PURCHASE** stating the buyer's name, date of purchase, name and address of the distributor.
- 10.2 Does not function properly, first check the battery and replace if necessary (see 7. battery replacement).

	Consult instructions for use	LOT	Batch code. YYMMA: year, year, month, month, serial number
	Atmospheric pressure limitation.	MD	Medical device.
	Humidity limitation.	REF	Catalogue number
	Temperature limitation.	IP22	Ingress Protection
	Disposal in accordance with Directive 2012/19/EC (WEEE)	CE 0 1 2 3	The product meets the legal requirements of the European Union.
	Type BF equipment		
<div><div><p>Dongguan Actherm Medical Corp. 3F, No. 21, Hai-bin Road, Wusha Community, Chang-An Town 523858 Dongguan City, Guangdong Province, PEOPLE'S REPUBLIC OF CHINA http://www.fortechgrp.com/actherm/</p></div><div><div>ECREP</div><div>MedPath GmbH Mies-van-der-Rohe-Strasse 8, 80807 Munich, Germany</div></div></div>			